

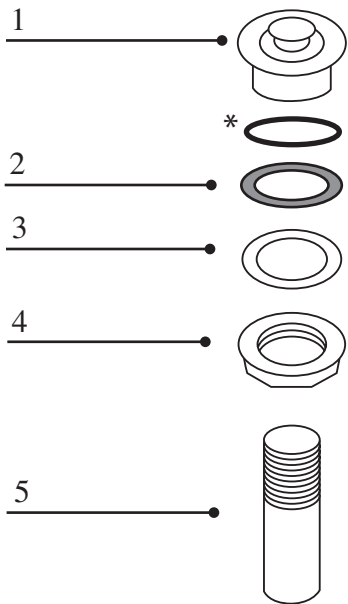

INSTALLATION INSTRUCTIONS

1.5" Lift & Turn Drain, DR160



1. Apply a small bead of 100% Silicone (non-water based) around the underside of strainer flange (1).

2. Assemble nut (4), gasket (2) and washer (3) (taper side up) to tailpiece (5). Thread tailpiece (5) into strainer flange (1) and tighten nut (2).

*Note: Rubber swasher is only used for glass sinks.

Remove all excess silicone around the drain after the drain has been installed

WWW.NATIVETRAILS.NET