

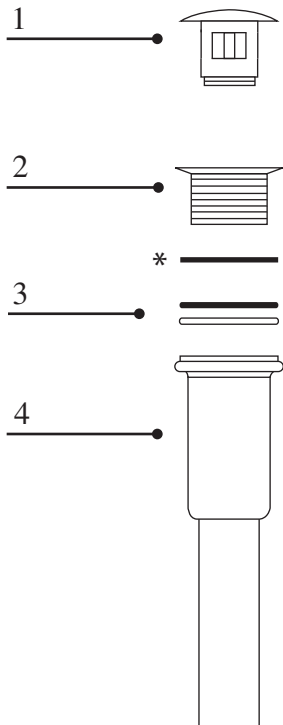

INSTALLATION INSTRUCTIONS

1.5" Dome Drain, DR120



1. Assemble seals (3) into the underbody (4)
2. Apply a small bead of 100% Silicone (non-water based) to the underside of the waste (2)
3. Locate the underbody (4) and seals (3) central to the underside of the vessel sink hole
4. Locate the waste (2) central to the top side of the vessel sink hole
5. Assemble decorative cover (1) as per diagram, hand tighten + $\frac{1}{4}$ turn.

* Note: Rubber washer is only used for glass sinks.

Remove all excess silicone around the drain after the drain has been installed