

SPECIFICATIONS

YANAMA VANITY

FRONT VIEW

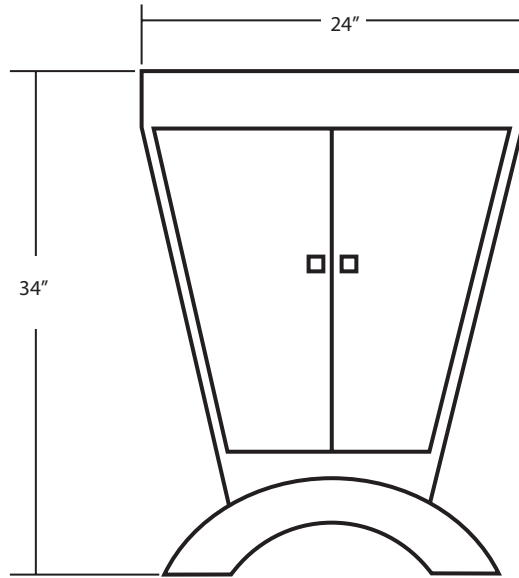

FEATURES

- * 24"w x 21.5"d x 34"h
- * FSC* certified Cherry
- * Hand hammered 16 gauge copper
- * Handcrafted & hand finished

FINISHES

- * Antique - VNF242
 - * Brushed Nickel - VNF245
- (Finish refers to arched copper foot)*

SIDE VIEW

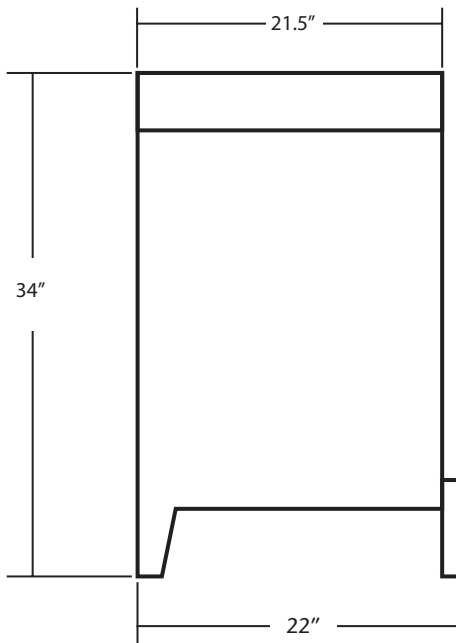

COORDINATING ACCESSORIES

- * Stone, Tuscany and Sedona vanity tops

IMPORTANT

Due to the handcrafted nature of this product, it will vary in finish and other details. Dimensions may vary up to 1/2".

- * Forest Stewardship Council